

SPECIFICATION DIESEL GENERATOR SET



Perkins®



Nagadiesel_id

www.nagadiesel.com

- **Features**
- High quality, reliable and complete generating sets.
- Every generating set carries a comprehensive test program which includes 25%, 50%, 75%, 100% , 110% loading test and series protecting function (example: Low oil pressure , High coolant temperature, over current/load etc.) check.
- Easy for operation and maintenance.
- Compact structure &high-strength chassis.
- Base frame design incorporates an intergrade fuel tank for at least 8 hours running.
- The canopy body painting adopts the HenKel pretreatment process and the base frame painting adopts sandblasting
- High-performance free-maintenance batteries with isolation switch.
- Anti- vibration pads are mounted between the engine/alternator feet and the base frame.
- Top lifting point and steel base frame with forklift holes, easy for transportation.
- Compliance with international electrical safety standards.
- Complete protection functions and safety labels.
- A large number of matching optional to meet the needs of various customers.
- User Manual

SPECIFICATION	OPEN TYPE	SILENT TYPE
Engine Manufac	Perkins Stamford	Perkins Stamford
Power Output	48KW/60KVA	48KW/60KVA
Phase	3 (three)	3 (three)
Frequency	50 Hz @1500 RPM	50 Hz @1500 RPM
Voltage	220/380V	220/380V
Accessories	Fuel Tank, Residential Muffler	Fuel Tank, Residential Muffler
Efficiency	88,80%	88,80%
Dimension LxWxT	2070x 750x 1340mm	2500 x 1000x 1250mm
Weight	875 kg	1179 kg
Fuel tank	104	104

Also available in the following voltages:
415/240V, 380/220V, 220/127V, 200/115V (According to customer requirements).

Rated Power/prime Power(PRP) :

Continuous running at variable load for unlimited periods with 10% overload available for 1 hour in any 12 hour period, in accordance with ISO8528.

Standby Power/Emergency Standby Power (ESP):

The maximum power available during a variable electrical power sequence, no overload on these ratings, in accordance with ISO 8528.



Genset Silent



Genset Open

*Gambar Mesin Hanya Ilustrasi

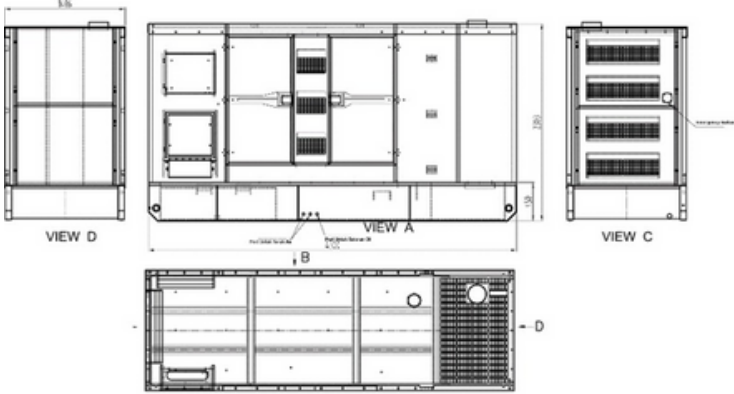

*Gambar Mesin Hanya Ilustrasi

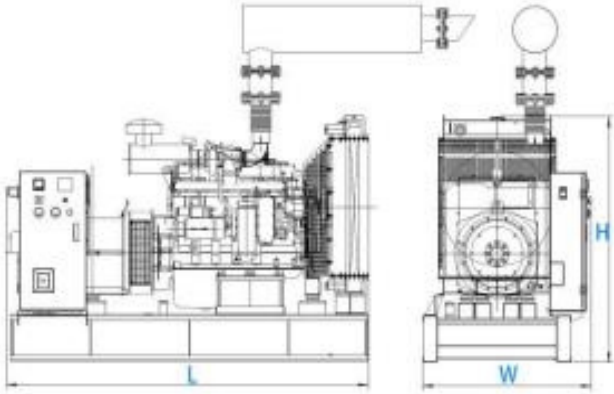

*Gambar Mesin Hanya Ilustrasi

Engine Specifications	
Engine model	VG-60P
Aspiration	turbocharged
Bore And Stroke	105 x 127 mm
Displacement	3.300 liters
Compression Ratio	17.25:1
Prime Power/speed	53.8KW / 1500rpm
Standby Power/speed	59.3KW / 1500rpm
Speed governor	Mechanical
Cooling System	Forced Water Cooling Cycle
Steady speed droop	≤1%
Coolant capacity	10.2L
Fuel Consumption (L/H)	217.7 g/Kw.h (at 1500RPM)

- **Heavy duty Perkins diesel engine**
- **Four stroke, water cooled, Turbocharged aspirated**
- **Direct injection fuel system**
- **Electric governor system**
- **12V DC starter and charge alternator**
- **Replaceable fuel filter and dry element air filter**
- **Cooling radiator and fan**
- **Starter battery(with lead acid) including rack and cables**
- **Flexible fuel connection hoses**
- **Industrial capacity exhaust silencer and steel bellows**
- **Operation manuals and circuit diagram documents**

Alternator Specifications	
Starter motor	DC 12V
DC 12V	DC 12V
Exciter type	Self excitation, Brushless
Power factor	0,8
Voltage adjust range	$\geq 5\%$
Voltage regulation NL-FL	$\leq \pm 1\%$
Insulation grade	H
Protection grade	IP23
Xd DIR. AXIS SYNCHRONOUS	2,24
X'd DIR. AXIS TRANSIENT	0,17
X''d DIR. AXIS SUBTRANSIENT	0,12
Xq QUAD. AXIS RECTANCE	1,02

Control System

DSE6120 (Deepsea)



DSE4620 (Deepsea)



DSE7320 (Deepsea)



Suitable for > 250KVA Gen - sets

Suitable for for all series Gen - sets

The Controller Display DSE6120	Control System	DSE7320 Control System
Voltage between phases(L-L)	✓	✓
Voltage between neutral and phase(L-N)	✓	✓
Frequency	✓	✓
3 Phase current	✓	✓
Real power(kW) and apparent power(kVA) Power factor	✓	✓
Engine speed	✓	✓
Running hours	✓	✓
Coolant temperature	✓	✓
Oil pressure	✓	✓
Battery voltage	✓	✓
LCD alarm indication	✓	✓
3 Phase mains (utility) sensing	✓	✓
Emergency stop button	✓	✓
High coolant temperature	✓	✓
Low oil pressure	✓	✓
Over current/load	✓	✓
under/over speed, frequency & voltage	✓	✓
Low/High battery voltage	✓	✓
Low coolant level	✓	✓